

ABERNATHY and ASSOCIATES

Kenneth B. Abernathy Jr.

Wisconsin Registered Land Surveyor S-1594

Rt. 3, Box 273
Elkhorn, Wisconsin 53121
Phone: (414) 723-4260 (office)
(414) 723-7209 (FAX)

PLAT OF SURVEY

PART OF LOT 13 OF BLOCK 2 OF WOODDALE
ADDITION LOCATED IN SECTION 9, TOWN 1
NORTH, RANGE 17 EAST, WALWORTH COUNTY,
WISCONSIN.

OWNERS: WAYNE AND JUDITH VESELSKY
902 E. CHERRY LANE
ARLINGTON HEIGHTS, IL. 60004

SUBJECT PROPERTY: 1899 BEACH RD.

PART OF LOT 13

PART OF LOT 13
5999 S.F.

EXISTING RESIDENCE

BEACH ROAD 40' WIDE

RADIUS = 558'

POWER POLE

PLATTED NORTH

SCALE 1" = 10 FEET

LOT 12

Legend

- FOUND IRON PIPE
- FOUND IRON ROD
- FOUND BRASS CAPPED MONUMENT
- FOUND CONCRETE MONUMENT
- CHISEL CUT IN CONCRETE
- SET IRON ROD, 24" LONG, WEIGHING
1.5 LBS. LINEAL FT., 3/4" DIA.
- SET IRON ROD, 30" LONG, WEIGHING
4.5 LBS. LINEAL FT., 1 1/16" DIA.
- (XX) RECORDED AS DIMENSION
- X-X- EXISTING FENCE

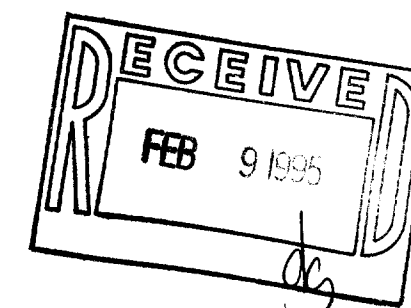

SCALE: 1" = 10 FEET

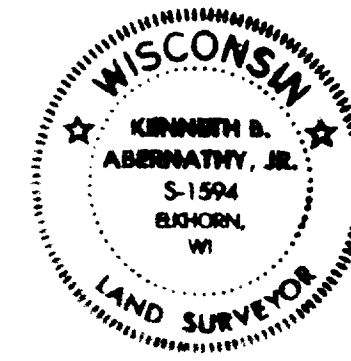

"I hereby certify that the above described property has been surveyed
by me or under my direction and that the above map is a true
representation thereof and shows the size and location of the property, its
exterior boundaries, the location of all visible structures and dimensions of
all principal buildings thereon, boundary fences, apparent easements,
roadways and visible encroachments, if any."
"This survey is made for the use of the present owners of the property,
and also those who purchase, mortgage, or guarantee the title thereto within
one year from date hereof."

Kenneth B. Abernathy Jr.
KENNETH B. ABERNATHY, JR.
WISCONSIN REGISTERED LAND SURVEYOR,
S-1594
ELKHORN, WI

Date: 12-28-94 Job No. 94-1217